



Piper
INDUSTRIES, INC.

FACE SEAL O-RING ADAPTERS

STANDARDS AND SPECIALS

• DESIGNED • ENGINEERED • MANUFACTURED •

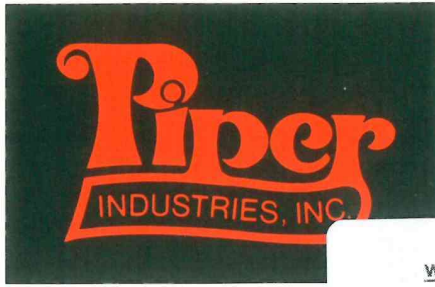

Visit us at:
www.piperindustries.com
1-800-521-1002
Phone: (586) 771-5100
Fax: (586) 771-9100

MANUFACTURERS OF HYDRAULIC FIT
15930 Common Road • P.O. Box 41 • Roseville, MI 48066 •

O-Ring Face Seal Adapters Index

Piper Industries Incorporated		Page Number
FS-0100	Male Connector	1
FS-0130	Male Branch Tee	2
FS-0145	45° Male Elbow	2
FS-0190	90° Male Elbow	3
FS-0400-SH	Union	4
FS-0430	Union Tee	4
FS-0440	Union Cross	5
FS-0490	90° Union Elbow	5
FS-0510	Plug	6
FS-0520	Cap	6
FS-0530	Reducer	7
FS-0620	Swivel Run Tee	7
FS-0630	Swivel Branch Tee	8
FS-0690	90° Swivel Elbow	8
FS-0700	Straight Thread Connector	9
FS-0700-XL	Long Straight Thread Connector	10
FS-0720	Straight Thread Run Tee	10
FS-0730	Straight Thread Branch Tee	11
FS-0745	45° Straight Thread Elbow	11
FS-0790	90° Straight Thread Elbow	12
FS-0790-L	90° Straight Thread Elbow Long	13
FS-1000	Bulkhead Union	13
FS-1020	Bulkhead Run Tee	14
FS-1030	Bulkhead Branch Tee	14
FS-1045	45° Bulkhead Elbow	15
FS-1090	90° Bulkhead Elbow	15
FS-1801	Nut	16
FS-1802	Sleeve	16
FS-1804	Straight Thread Locknut	17
FS-1805	Bulkhead Locknut	17

MALE CONNECTOR

FS-0100

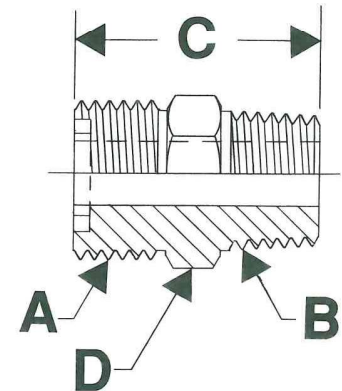

PART NO.	TUBE O.D.	THREAD A	THREAD B	DIM. C	HEX. D	HOLE SIZE
FS-0100-04-02	.250	9/16-18	1/8-27	1.03	.62	.17
FS-0100-04-04	.250	9/16-18	1/4-18	1.24	.62	.17
FS-0100-04-06	.250	9/16-18	3/8-18	1.24	.75	.17
FS-0100-04-08	.250	9/16-18	1/2-14	1.49	.88	.17
FS-0100-06-04	.375	11/16-16	1/4-18	1.30	.75	.26
FS-0100-06-06	.375	11/16-16	3/8-18	1.30	.75	.26
FS-0100-06-08	.375	11/16-16	1/2-14	1.55	.88	.26
FS-0100-08-04	.500	13/16-16	1/4-18	1.36	.88	.28
FS-0100-08-06	.500	13/16-16	3/8-18	1.36	.88	.38
FS-0100-08-08	.500	13/16-16	1/2-14	1.61	.88	.38
FS-0100-08-12	.500	13/16-16	3/4-14	1.68	1.06	.38
FS-0100-10-08	.625	1-14	1/2-14	1.72	1.06	.48
FS-0100-10-12	.625	1-14	3/4-14	1.78	1.06	.48
FS-0100-12-08	.750	1-3/16-12	1/2-14	1.84	1.25	.53
FS-0100-12-12	.750	1-3/16-12	3/4-14	1.84	1.25	.61
FS-0100-12-16	.750	1-3/16-12	1-11 1/2	2.03	1.38	.61
FS-0100-16-12	1.000	1-7/16-12	3/4-14	1.86	1.50	.72
FS-0100-16-16	1.000	1-7/16-12	1-11 1/2	2.05	1.50	.81
FS-0100-16-20	1.000	1-7/16-12	1-1/4-11	2.16	1.69	.81
FS-0100-20-16	1.250	1-11/16-12	1-11 1/2	2.13	1.75	.94
FS-0100-20-20	1.250	1-11/16-12	1-1/4 - 11 1/2	2.16	1.75	1.02
FS-0100-24-24	1.500	2-12	1-1/2- 11 1/2	2.26	2.12	1.26



MALE BRANCH TEE

FS-0130

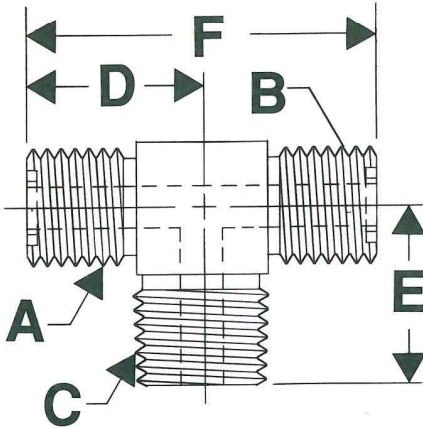

PART NO.	TUBE O.D.	THREAD A	THREAD B	THREAD C	DIM. D	DIM. E	DIM. F	HOLE SIZE
FS-0130-04-04-02	.250	9/16-18	9/16-18	1/8-27	.85	.78	1.70	.17
FS-0130-06-06-04	.375	11/16-16	11/16-16	1/4-18	.98	1.09	1.96	.26
FS-0130-06-06-06	.375	11/16-16	11/16-16	3/8-18	1.04	1.22	2.08	.26
FS-0130-08-08-06	.500	13/16-16	13/16-16	3/8-18	1.10	1.22	2.20	.38
FS-0130-08-08-08	.500	13/16-16	13/16-16	1/2-14	1.21	1.53	2.42	.38
FS-0130-10-10-08	.625	1-14	1-14	1/2-14	1.31	1.53	2.62	.48
FS-0130-12-12-12	.750	1-3/16-12	1-3/16-12	3/4-14	1.47	1.65	2.94	.61
FS-0130-16-16-16	1.000	1-7/16-12	1-7/16-12	1-11 1/2	1.64	2.03	3.28	.81
FS-0130-20-20-20	1.250	1-11/16-12	1-11/16-12	1-1/4-11 1/2	1.76	2.42	3.52	1.02
FS-0130-24-24-24	1.500	2-12	2-12	1-1/2-11 1/2	1.92	2.70	3.84	1.26

45° MALE ELBOW

FS-0145

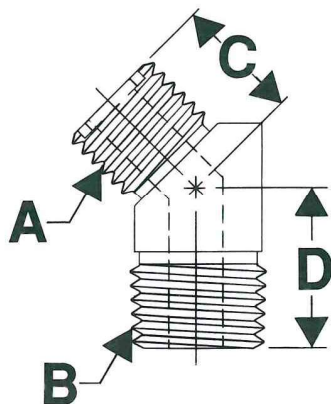

PART NO.	TUBE O.D.	THREAD A	THREAD B	DIM. C	DIM. D	HOLE SIZE
FS-0145-04-02	.250	9/16-18	1/8-27	.63	.68	.17
FS-0145-04-04	.250	9/16-18	1/4-18	.68	.93	.17
FS-0145-04-06	.250	9/16-18	3/8-18	.67	1.04	.17
FS-0145-06-04	.375	11/16-16	1/4-18	.74	.93	.26
FS-0145-06-06	.375	11/16-16	3/8-18	.74	1.04	.26
FS-0145-08-04	.500	13/16-16	1/4-18	.80	.92	.28
FS-0145-08-06	.500	13/16-16	3/8-18	.80	1.04	.38
FS-0145-08-08	.500	13/16-16	1/2-14	.82	1.20	.38
FS-0145-10-08	.625	1-14	1/2-14	.92	1.20	.48
FS-0145-12-12	.750	1-3/16-12	3/4-14	1.02	1.23	.61
FS-0145-16-16	1.000	1-7/16-12	1-11 1/2	1.18	1.51	.81
FS-0145-20-20	1.250	1-11/16-12	1-1/4-11 1/2	1.26	1.69	1.02
FS-0145-24-24	1.500	2-12	1-1/2-11 1/2	1.45	1.80	1.26

90° MALE ELBOW

FS-0190

PART NO.	TUBE O.D.	THREAD A	THREAD B	DIM. C	DIM. D	HOLE SIZE
FS-0190-04-02	.250	9/16-18	1/8-27	.85	.78	.17
FS-0190-04-04	.250	9/16-18	1/4-18	.92	1.09	.17
FS-0190-06-04	.375	11/16-16	1/4-18	.98	1.07	.26
FS-0190-06-06	.375	11/16-16	3/8-18	1.04	1.22	.26
FS-0190-06-08	.375	11/16-16	1/2-14	1.15	1.53	.26
FS-0190-08-04	.500	13/16-16	1/4-18	1.10	1.13	.26
FS-0190-08-06	.500	13/16-16	3/8-18	1.10	1.22	.38
FS-0190-08-08	.500	13/16-16	1/2-14	1.21	1.53	.38
FS-0190-08-12	.500	13/16-16	3/4-14	1.32	1.65	.38
FS-0190-10-08	.625	1-14	1/2-14	1.31	1.53	.48
FS-0190-10-12	.625	1-14	3/4-14	1.41	1.65	.48
FS-0190-12-08	.750	1-3/16-12	1/2-14	1.47	1.65	.53
FS-0190-12-12	.750	1-3/16-12	3/4-14	1.47	1.65	.61
FS-0190-12-16	.750	1-3/16-12	1-11 1/2	1.62	2.03	.61
FS-0190-16-12	1.000	1-7/16-12	3/4-14	1.64	1.84	.72
FS-0190-16-16	1.000	1-7/16-12	1-11 1/2	1.64	2.03	.81
FS-0190-20-20	1.250	1-11/16-12	1-1/4-11 1/2	1.76	2.42	1.02
FS-0190-24-24	1.500	2-12	1-1/2-11 1/2	1.92	2.70	1.26

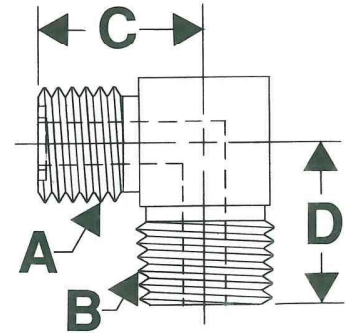

UNION
(520101)

FS-0400-SH

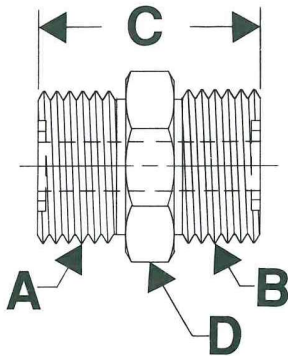

PART NO.	TUBE O.D.	THREAD A	THREAD B	DIM. C	HEX. D	HOLE SIZE
FS-0400-SH-04-04	.250	9/16-18	9/16-18	1.08	.62	.17
FS-0400-SH-06-04	.375	11/16-16	9/16-18	1.17	.75	.17
FS-0400-SH-06-06	.375	11/16-16	11/16-16	1.22	.75	.26
FS-0400-SH-08-06	.500	13/16-16	11/16-16	1.33	.88	.26
FS-0400-SH-08-08	.500	13/16-16	13/16-16	1.39	.88	.38
FS-0400-SH-10-08	.625	1-14	13/16-16	1.57	1.06	.38
FS-0400-SH-10-10	.625	1-14	1-14	1.68	1.06	.48
FS-0400-SH-12-10	.750	1-3/16-12	1-14	1.80	1.25	.48
FS-0400-SH-12-12	.750	1-3/16-12	1-3/16-12	1.86	1.25	.61
FS-0400-SH-16-12	1.000	1-7/16-12	1-3/16-12	1.92	1.50	.61
FS-0400-SH-16-16	1.000	1-7/16-12	1-7/16-12	1.94	1.50	.81
FS-0400-SH-20-20	1.250	1-11/16-12	1-11/16-12	2.02	1.75	1.02
FS-0400-SH-24-24	1.500	2-12	2-12	2.09	2.12	1.26

UNION TEE
(520401)

FS-0430

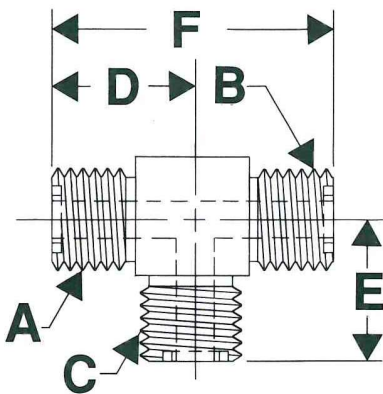

PART NO.	TUBE O.D.	THREAD A	THREAD B	THREAD C	DIM. D	DIM. E	DIM. F	HOLE SIZE
FS-0430-04-04-04	.250	9/16-18	9/16-18	9/16-18	.85	.85	1.70	.17
FS-0430-06-06-06	.375	11/16-16	11/16-16	11/16-16	.98	.98	1.96	.26
FS-0430-08-08-08	.500	13/16-16	13/16-16	13/16-16	1.10	1.10	2.20	.38
FS-0430-10-10-10	.625	1-14	1-14	1-14	1.31	1.31	2.62	.48
FS-0430-12-12-12	.750	1-3/16-12	1-3/16-12	1-3/16-12	1.47	1.47	2.94	.61
FS-0430-16-16-16	1.000	1-7/16-12	1-7/16-12	1-7/16-12	1.64	1.64	3.28	.81
FS-0430-20-20-20	1.250	1-11/16-12	1-11/16-12	1-11/16-12	1.76	1.76	3.52	1.02
FS-0430-24-24-24	1.500	2-12	2-12	2-12	1.92	1.92	3.84	1.26

PART NO.	TUBE O.D.	THREAD A	THREAD B	THREAD C	THREAD D	DIM. E	DIM. F	HOLE SIZE
FS-0440-04-04-04-04	.250	9/16-18	9/16-18	9/16-18	9/16-18	.85	1.70	.17
FS-0440-06-06-06-06	.375	11/16-16	11/16-16	11/16-16	11/16-16	.98	1.96	.26
FS-0440-08-08-08-08	.500	13/16-16	13/16-16	13/16-16	13/16-16	1.10	2.20	.38
FS-0440-10-10-10-10	.625	1-14	1-14	1-14	1-14	1.31	2.62	.48
FS-0440-12-12-12-12	.750	1-3/16-12	1-3/16-12	1-3/16-12	1-3/16-12	1.47	2.94	.61
FS-0440-16-16-16-16	1.000	1-7/16-12	1-7/16-12	1-7/16-12	1-7/16-12	1.64	3.28	.81
FS-0440-20-20-20-20	1.250	1-11/16-12	1-11/16-12	1-11/16-12	1-11/16-12	1.76	3.52	1.02
FS-0440-24-24-24-24	1.500	2-12	2-12	2-12	2-12	1.92	3.84	1.26

UNION CROSS

(520501)

FS-0440

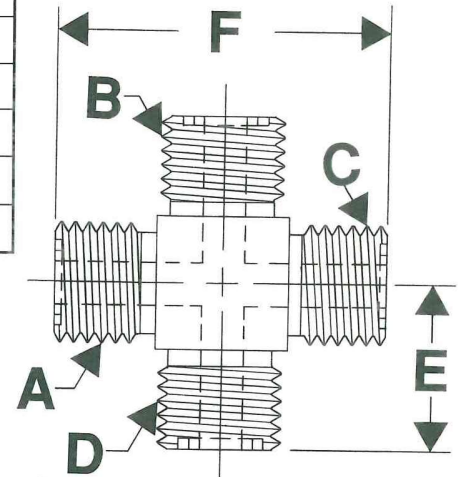

PART NO.	TUBE O.D.	THREAD A	THREAD B	DIM. C	DIM. D	HOLE SIZE
FS-0490-04-04	.250	9/16-18	9/16-18	.85	.85	.17
FS-0490-06-04	.375	11/16-16	9/16-18	.98	.92	.17
FS-0490-06-06	.375	11/16-16	11/16-16	.98	.98	.26
FS-0490-08-04	.500	13/16-16	9/16-18	1.10	.97	.17
FS-0490-08-06	.500	13/16-16	11/16-16	1.10	1.04	.26
FS-0490-08-08	.500	13/16-16	13/16-16	1.10	1.10	.38
FS-0490-10-10	.625	1-14	1-14	1.31	1.31	.48
FS-0490-12-12	.750	1-3/16-12	1-3/16-12	1.47	1.47	.61
FS-0490-16-16	1.00	1-7/16-12	1-7/16-12	1.64	1.64	.81
FS-0490-20-20	1.25	1-11/16-12	1-11/16-12	1.76	1.76	1.02
FS-0490-24-24	1.50	2-12	2-12	1.92	1.92	1.26

90° UNION ELBOW

(520201)

FS-0490

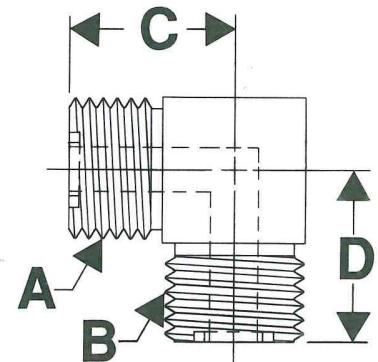

PLUG
(520109)
FS-0510

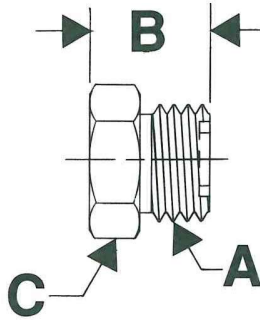

PART NO.	TUBE O.D.	THREAD A	DIM. B	HEX. C
FS-0510-04	.250	9/16-18	.66	.62
FS-0510-06	.375	11/16-16	.75	.75
FS-0510-08	.500	13/16-16	.86	.88
FS-0510-10	.625	1-14	1.02	1.06
FS-0510-12	.750	1-3/16-12	1.08	1.25
FS-0510-16	1.00	1-7/16-12	1.10	1.50
FS-0510-20	1.25	1-11/16-12	1.10	1.75
FS-0510-24	1.50	2-12	1.10	2.12

CAP
(520112)
FS-0520

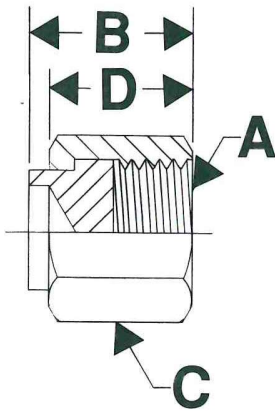

PART NO.	TUBE O.D.	THREAD A	DIM. B	HEX. C	DIM. D
FS-0520-04	.250	9/16-18	.66	.69	.58
FS-0520-06	.375	11/16-16	.75	.81	.67
FS-0520-08	.500	13/16-16	.90	.94	.83
FS-0520-10	.625	1-14	1.00	1.12	.93
FS-0520-12	.750	1-3/16-12	1.10	1.38	1.02
FS-0520-16	1.000	1-7/16-12	1.17	1.62	1.10
FS-0520-20	1.250	1-11/16-12	1.17	1.88	1.10
FS-0520-24	1.500	2-12	1.17	2.25	1.10

PART NO.	TUBE O.D.	THREAD A	THREAD B	DIM. C	HEX D	HOLE SIZE
FS-0530-04-08	.500	9/16-18	13/16-16	.86	.94	.17
FS-0530-04-10	.625	9/16-18	1-14	.90	1.12	.17
FS-0530-06-10	.625	11/16-16	1-14	.95	1.12	.26
FS-0530-08-10	.625	13/16-16	1-14	1.02	1.12	.38
FS-0530-04-12	.750	9/16-18	1-3/16-12	.98	1.38	.17
FS-0530-06-12	.750	11/16-16	1-3/16-12	1.03	1.38	.26
FS-0530-08-12	.750	13/16-16	1-3/16-12	1.10	1.38	.38
FS-0530-08-16	1.000	13/16-16	1-7/16-12	1.15	1.62	.38
FS-0530-10-16	1.000	1-14	1-7/16-12	1.26	1.62	.48

TUBE END REDUCER

FS-0530

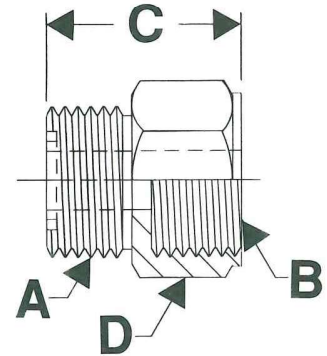

PART NO.	TUBE O.D.	THREAD A	THREAD B	THREAD C	DIM. D	DIM. E	DIM. F	HOLE SIZE
FS-0620-04-04-04	.250	9/16-18	9/16-18	9/16-18	.85	.85	1.89	.17
FS-0620-06-06-06	.375	11/16-16	11/16-16	11/16-16	.98	.98	2.13	.26
FS-0620-08-08-08	.500	13/16-16	13/16-16	13/16-16	1.10	1.10	2.59	.36
FS-0620-10-10-10	.625	1-14	1-14	1-14	1.31	1.31	2.93	.46
FS-0620-12-12-12	.750	1-3/16-12	1-3/16-12	1-3/16-12	1.47	1.47	3.29	.55
FS-0620-16-16-16	1.000	1-7/16-12	1-7/16-12	1-7/16-12	1.64	1.64	3.74	.78
FS-0620-20-20-20	1.250	1-11/16-12	1-11/16-12	1-11/16-12	1.76	1.76	4.05	1.02
FS-0620-24-24-24	1.500	2-12	2-12	2-12	1.92	1.92	4.33	1.26

SWIVEL RUN TEE

(SAE 520432)

FS-0620

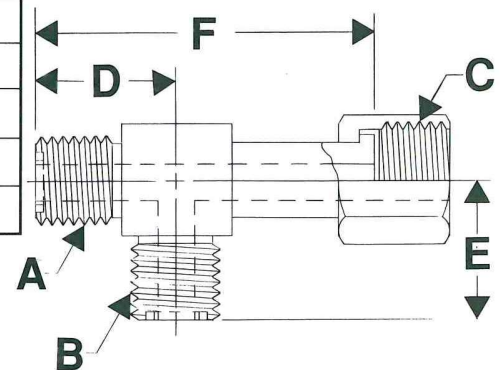



SWIVEL BRANCH TEE (520433)

FS-0630

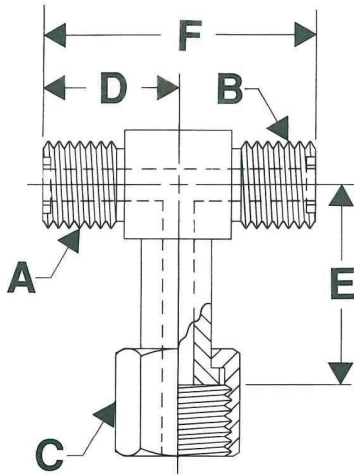

PART NO.	TUBE O.D.	THREAD A	THREAD B	THREAD C	DIM. D	DIM. E	DIM. F	HOLE SIZE
FS-0630-04-04-04	.250	9/16-18	9/16-18	9/16-18	.85	1.04	1.70	.17
FS-0630-06-06-06	.375	11/16-16	11/16-16	11/16-16	.98	1.15	1.96	.26
FS-0630-08-08-08	.500	13/16-16	13/16-16	13/16-16	1.10	1.49	2.20	.36
FS-0630-10-10-10	.625	1-14	1-14	1-14	1.31	1.62	2.62	.46
FS-0630-12-12-12	.750	1-3/16-12	1-3/16-12	1-3/16-12	1.47	1.82	2.94	.55
FS-0630-16-16-16	1.000	1-7/16-12	1-7/16-12	1-7/16-12	1.64	2.10	3.28	.78
FS-0630-20-20-20	1.250	1-11/16-12	1-11/16-12	1-11/16-12	1.76	2.29	3.52	1.02
FS-0630-24-24-24	1.500	2-12	2-12	2-12	1.92	2.41	3.84	1.26

90° SWIVEL ELBOW (520221)

FS-0690

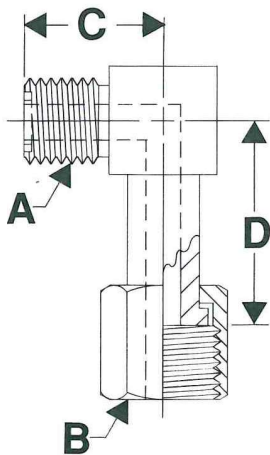

PART NO.	TUBE O.D.	THREAD A	THREAD B	DIM. C	DIM. D	HOLE SIZE
FS-0690-04-04	.250	9/16-18	9/16-18	.85	1.04	.17
FS-0690-06-06	.375	11/16-18	11/16-18	.98	1.15	.26
FS-0690-08-08	.500	13/16-16	13/16-16	1.10	1.49	.36
FS-0690-10-10	.625	1-14	1-14	1.31	1.62	.46
FS-0690-12-12	.750	1-3/16-12	1-3/16-12	1.47	1.82	.55
FS-0690-16-16	1.000	1-7/16-12	1-7/16-12	1.64	2.10	.78
FS-0690-20-20	1.250	1-11/16-12	1-11/16-12	1.76	2.29	1.02
FS-0690-24-24	1.500	2-12	2-12	1.92	2.41	1.26

STRAIGHT THREAD CONNECTOR

(520120)

FS-0700

PART NO.	TUBE O.D.	THREAD A	THREAD B	DIM. C	DIM. D	HOLE SIZE	HEX. E
FS-0700-04-04	.250	9/16-18	7/16-20	1.13	.43	.17	.62
FS-0700-04-06	.250	9/16-18	9/16-18	1.20	.47	.17	.69
FS-0700-04-08	.250	9/16-18	3/4-16	1.32	.55	.17	.88
FS-0700-06-04	.375	11/16-16	7/16-20	1.34	.43	.17	.75
FS-0700-06-05	.375	11/16-16	1/2-20	1.22	.43	.23	.75
FS-0700-06-06	.375	11/16-16	9/16-18	1.25	.47	.26	.75
FS-0700-06-08	.375	11/16-16	3/4-16	1.38	.55	.26	.88
FS-0700-06-10	.375	11/16-16	7/8-14	1.53	.63	.26	1.00
FS-0700-08-06	.500	13/16-16	9/16-18	1.48	.47	.30	.88
FS-0700-08-08	.500	13/16-16	3/4-16	1.44	.55	.38	.88
FS-0700-08-10	.500	13/16-16	7/8-14	1.59	.63	.38	1.00
FS-0700-08-12	.500	13/16-16	1-1/16-12	1.75	.73	.38	1.25
FS-0700-10-08	.625	1-14	3/4-16	1.78	.55	.39	1.06
FS-0700-10-10	.625	1-14	7/8-14	1.70	.63	.48	1.06
FS-0700-10-12	.625	1-14	1-1/16-12	1.86	.73	.48	1.25
FS-0700-12-06	.750	1-3/16-12	9/16-18	1.77	.47	.30	1.25
FS-0700-12-08	.750	1-3/16-12	3/4-16	1.91	.55	.39	1.25
FS-0700-12-10	.750	1-3/16-12	7/8-14	1.99	.63	.48	1.25
FS-0700-12-12	.750	1-3/16-12	1-1/16-12	1.92	.73	.61	1.25
FS-0700-12-14	.750	1-3/16-12	1-3/16-12	1.92	.73	.61	1.38
FS-0700-12-16	.750	1-3/16-12	1-5/16-12	1.96	.73	.61	1.50
FS-0700-16-12	1.00	1-7/16-12	1-1/16-12	2.14	.73	.61	1.50
FS-0700-16-16	1.00	1-7/16-12	1-5/16-12	1.98	.73	.81	1.50
FS-0700-16-20	1.00	1-7/16-12	1-5/8-12	2.06	.73	.81	1.88
FS-0700-20-16	1.25	1-11/16-12	1-5/16-12	2.28	.73	.84	1.75
FS-0700-20-20	1.25	1-11/16-12	1-5/8-12	2.06	.73	1.02	1.88
FS-0700-20-24	1.25	1-11/16-12	1-7/8-12	2.06	.73	1.02	2.12
FS-0700-24-20	1.50	2-12	1-5/8-12	2.35	.73	1.02	2.12
FS-0700-24-24	1.50	2-12	1-7/8-12	2.13	.73	1.26	2.12

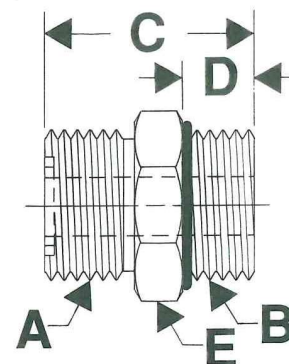



LONG STRAIGHT THREAD CONNECTOR

FS-0700-XL

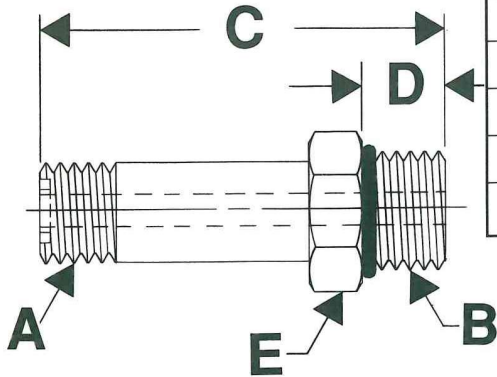

PART NO.	TUBE O.D.	THREAD A	THREAD B	DIM. C	DIM. D	HEX. E	HOLE SIZE
FS-0700-XL-04-04	.250	9/16-18	7/16-20	2.07	.43	.63	.17
FS-0700-XL-06-06	.375	11/16-16	9/16-18	2.27	.47	.75	.26
FS-0700-XL-06-08	.375	11/16-16	3/4-16	2.61	.55	.88	.26
FS-0700-XL-08-08	.500	13/16-16	3/4-16	2.67	.55	.88	.38
FS-0700-XL-10-10	.625	1-14	7/8-14	3.13	.63	1.06	.48
FS-0700-XL-12-12	.750	1-3/16-12	1-1/16-12	3.75	.73	1.25	.61
FS-0700-XL-16-16	1.000	1-7/16-12	1-5/16-12	4.13	.73	1.50	.81
FS-0700-XL-20-20	1.250	1-11/16-12	1-5/8-12	4.75	.73	1.88	1.05
FS-0700-XL-24-24	1.500	2-12	1-7/8-12	5.26	.73	2.12	1.31

STRAIGHT THREAD RUN TEE

(520428)

FS-0720

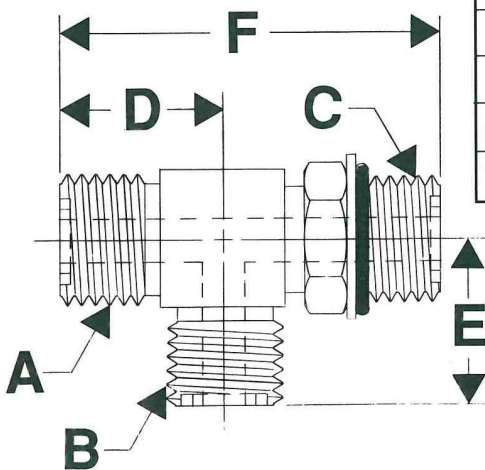

PART NO.	TUBE O.D.	THREAD A	THREAD B	THREAD C	DIM. D	DIM. E	DIM. F	HOLE SIZE
FS-0720-04-04-04	.250	9/16-18	9/16-18	7/16-20	.85	.85	2.14	.17
FS-0720-06-06-06	.375	11/16-16	11/16-16	9/16-18	.98	.98	2.43	.26
FS-0720-08-08-08	.500	13/16-16	13/16-16	3/4-16	1.10	1.10	2.70	.38
FS-0720-10-10-10	.625	1-14	1-14	7/8-14	1.31	1.31	3.28	.48
FS-0720-12-12-12	.750	1-3/16-12	1-3/16-12	1-1/16-12	1.47	1.47	3.64	.61
FS-0720-16-16-16	1.000	1-7/16-12	1-7/16-12	1-5/16-12	1.64	1.64	3.99	.81
FS-0720-20-20-20	1.250	1-11/16-12	1-11/16-12	1-5/8-12	1.76	1.76	4.21	1.02
FS-0720-24-24-24	1.500	2-12	2-12	1-7/8-12	1.92	1.92	4.51	1.26

STRAIGHT THREAD BRANCH TEE

(520429)

FS-0730

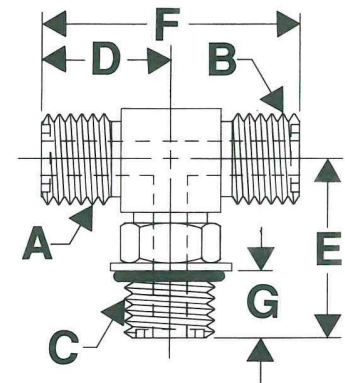

45° STRAIGHT THREAD ELBOW

(520320)

FS-0745

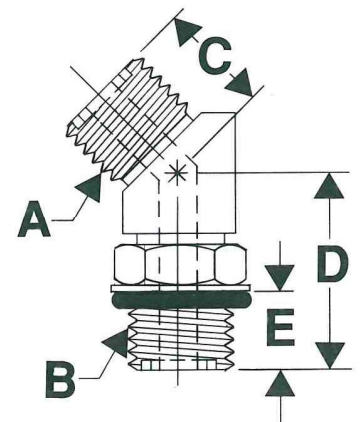

PART NO.	TUBE O.D.	THREAD A	THREAD B	THREAD C	DIM. D	DIM. E	DIM. F	DIM. G
FS-0730-04-04-04	.250	9/16-18	9/16-18	7/16-20	.85	1.29	1.70	.43
FS-0730-06-06-06	.375	11/16-16	11/16-16	9/16-18	.98	1.45	1.96	.47
FS-0730-06-06-08	.375	11/16-16	11/16-16	3/4-16	1.04	1.60	2.08	.55
FS-0730-08-08-08	.500	13/16-16	13/16-16	3/4-16	1.10	1.60	2.20	.55
FS-0730-10-10-10	.625	1-14	1-14	7/8-14	1.31	1.97	2.62	.63
FS-0730-12-12-10	.750	1-3/16-12	1-3/16-12	7/8-14	1.47	2.01	2.94	.63
FS-0730-12-12-12	.750	1-3/16-12	1-3/16-12	1-1/16-12	1.47	2.17	2.94	.73
FS-0730-16-16-16	1.000	1-7/16-12	1-7/16-12	1-5/16-12	1.64	2.35	3.28	.73
FS-0730-20-20-20	1.250	1-11/16-12	1-11/16-12	1-5/8-12	1.76	2.45	3.52	.73
FS-0730-24-24-24	1.500	2-12	2-12	1-7/8-12	1.92	2.59	3.84	.73

PART NO.	TUBE O.D.	THREAD A	THREAD B	DIM. C	DIM. D	DIM. E	HOLE SIZE
FS-0745-04-04	.250	9/16-18	7/16-20	.63	1.18	.37	.17
FS-0745-04-06	.250	9/16-18	9/16-18	.68	1.30	.47	.17
FS-0745-04-08	.250	9/16-18	3/4-16	.67	1.43	.55	.17
FS-0745-06-04	.375	11/16-16	7/16-20	.74	1.22	.43	.17
FS-0745-06-06	.375	11/16-16	9/16-18	.74	1.30	.47	.26
FS-0745-06-08	.375	11/16-16	3/4-16	.74	1.43	.55	.26
FS-0745-08-06	.500	13/16-16	9/16-18	.80	1.29	.47	.30
FS-0745-08-08	.500	13/16-16	3/4-16	.80	1.43	.55	.38
FS-0745-08-10	.500	13/16-16	7/8-14	.82	1.76	.63	.38
FS-0745-08-16	.500	13/16-16	1-5/16-12	1.01	2.06	.73	.38
FS-0745-10-08	.625	1-14	3/4-16	.92	1.59	.55	.38
FS-0745-10-10	.625	1-14	7/8-14	.92	1.76	.63	.48
FS-0745-10-12	.625	1-14	1-1/16-12	.96	1.97	.73	.48
FS-0745-12-10	.750	1-3/16-12	7/8-14	1.02	1.81	.63	.48
FS-0745-12-12	.750	1-3/16-12	1-1/16-12	1.02	1.97	.73	.61
FS-0745-12-16	.750	1-3/16-12	1-5/16-12	1.16	2.06	.73	.61
FS-0745-16-12	1.000	1-7/16-12	1-1/16-12	1.18	2.03	.73	.61
FS-0745-16-16	1.000	1-7/16-12	1-5/16-12	1.18	2.06	.73	.81
FS-0745-16-20	1.000	1-7/16-12	1-5/8-12	1.26	2.11	.73	.81
FS-0745-20-20	1.250	1-11/16-12	1-5/8-12	1.26	2.11	.73	1.02
FS-0745-24-24	1.500	2-12	1-7/8-12	1.45	2.11	.73	1.26



90° STRAIGHT THREAD ELBOW

(520220)

FS-0790

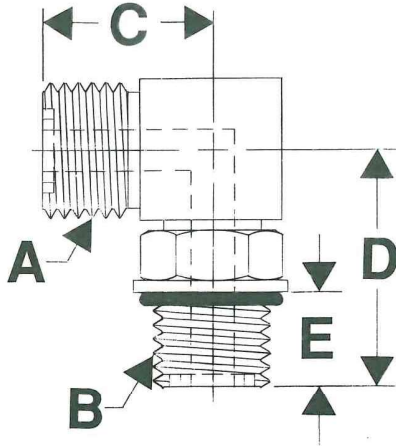

PART NO.	TUBE O.D.	THREAD A	THREAD B	DIM. C	DIM. D	DIM. E	HOLE SIZE
FS-0790-04-04	.250	9/16-18	7/16-20	.85	1.29	.43	.17
FS-0790-04-05	.250	9/16-18	1/2-20	.92	1.37	.43	.17
FS-0790-04-06	.250	9/16-18	9/16-18	.92	1.45	.47	.17
FS-0790-04-08	.250	9/16-18	3/4-16	.97	1.60	.55	.17
FS-0790-06-04	.375	11/16-16	7/16-20	.98	1.37	.43	.17
FS-0790-06-05	.375	11/16-16	1/2-20	.98	1.37	.43	.23
FS-0790-06-06	.375	11/16-16	9/16-18	.98	1.45	.47	.26
FS-0790-06-08	.375	11/16-16	3/4-16	1.04	1.60	.55	.26
FS-0790-06-10	.375	11/16-16	7/8-14	1.15	1.97	.63	.26
FS-0790-06-12	.375	11/16-16	1-1/16-12	1.25	2.17	.73	.26
FS-0790-08-06	.500	13/16-16	9/16-18	1.10	1.44	.47	.30
FS-0790-08-08	.500	13/16-16	3/4-16	1.10	1.60	.55	.38
FS-0790-08-10	.500	13/16-16	7/8-14	1.21	1.97	.63	.38
FS-0790-08-12	.500	13/16-16	1-1/16-12	1.32	2.17	.73	.38
FS-0790-10-08	.625	1-14	3/4-16	1.31	1.80	.55	.39
FS-0790-10-10	.625	1-14	7/8-14	1.31	1.97	.63	.48
FS-0790-10-12	.625	1-14	1-1/16-14	1.41	2.17	.73	.48
FS-0790-12-08	.750	1-3/16-12	3/4-16	1.47	1.84	.55	.39
FS-0790-12-10	.750	1-3/16-12	7/8-14	1.47	2.01	.63	.48
FS-0790-12-12	.750	1-3/16-12	1-1/16-12	1.47	2.17	.73	.61
FS-0790-12-16	.750	1-3/16-12	1-5/16-12	1.62	2.35	.73	.61
FS-0790-16-12	1.00	1-7/16-12	1-1/16-12	1.64	2.32	.73	.61
FS-0790-16-16	1.00	1-7/16-12	1-5/16-12	1.64	2.35	.73	.81
FS-0790-16-20	1.00	1-7/16-12	1-5/8-12	1.76	2.45	.73	.81
FS-0790-20-16	1.25	1-11/16-12	1-5/16-12	1.76	2.42	.73	.84
FS-0790-20-20	1.25	1-11/16-12	1-5/8-12	1.76	2.45	.73	1.02
FS-0790-24-20	1.50	2-12	1-5/8-12	1.92	2.56	.73	1.08
FS-0790-24-24	1.50	2-12	1-7/8-12	1.92	2.59	.73	1.26

90° STRAIGHT THREAD ELBOW LONG

FS-0790-L

PART NO.	TUBE O.D.	THREAD A	THREAD B	DIM. C	DIM. D	DIM. E	HOLE SIZE
FS-0790-L-04-04	.250	9/16-18	7/16-20	.85	2.23	.43	.17
FS-0790-L-06-06	.375	11/16-16	9/16-18	.98	2.61	.47	.26
FS-0790-L-08-08	.500	13/16-16	3/4-16	1.10	2.95	.55	.38
FS-0790-L-10-10	.625	1-14	7/8-14	1.31	3.51	.63	.48
FS-0790-L-12-12	.750	1-3/16-12	1-1/16-12	1.47	3.97	.73	.61
FS-0790-L-16-16	1.000	1-7/16-12	1-5/16-12	1.64	4.51	.73	.81
FS-0790-L-20-20	1.250	1-11/16-12	1-5/8-12	1.76	4.98	.73	1.02
FS-0790-L-24-24	1.500	2-12	1-7/8-12	1.92	5.48	.73	1.26

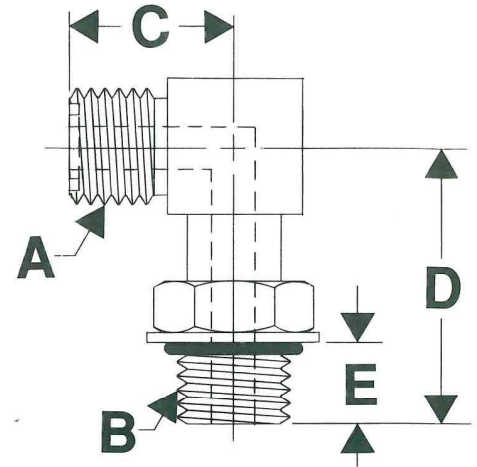

BULKHEAD UNION

(520601)

FS-1000

PART NO.	TUBE O.D.	THREAD A	THREAD B	DIM. C	DIM. D	HEX. E	HOLE SIZE
FS-1000-04-04	.250	9/16-18	9/16-18	1.90	1.24	.81	.17
FS-1000-06-06	.375	11/16-16	11/16-16	2.09	1.34	1.00	.26
FS-1000-08-08	.500	13/16-16	13/16-16	2.30	1.44	1.12	.38
FS-1000-10-10	.625	1-14	1-14	2.62	1.60	1.31	.48
FS-1000-12-12	.750	1-3/16-12	1-3/16-12	2.72	1.64	1.50	.61
FS-1000-16-16	1.000	1-7/16-12	1-7/16-12	2.76	1.66	1.75	.81
FS-1000-20-20	1.250	1-11/16-12	1-11/16-12	2.76	1.66	2.00	1.02
FS-1000-24-24	1.500	2-12	2-12	2.76	1.66	2.38	1.26

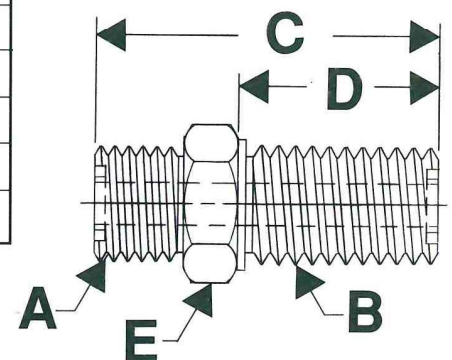



BULKHEAD TEE

(520958)

FS-1020

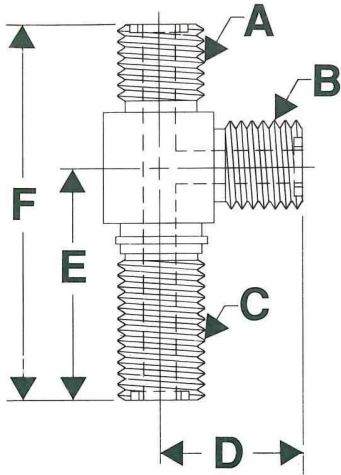

PART NO.	TUBE O.D.	THREAD A	THREAD B	THREAD C	DIM. D	DIM. E	DIM. F	HOLE SIZE
FS-1020-04-04-04	.250	9/16-18	9/16-18	9/16-18	.89	1.85	2.74	.17
FS-1020-06-06-06	.375	11/16-16	11/16-16	11/16-16	1.02	2.05	3.07	.26
FS-1020-08-08-08	.500	13/16-16	13/16-16	13/16-16	1.14	2.18	3.32	.38
FS-1020-10-10-10	.625	1-14	1-14	1-14	1.36	2.48	3.84	.48
FS-1020-12-12-12	.750	1-3/16-12	1-3/16-12	1-3/16-12	1.52	2.65	4.17	.61
FS-1020-16-16-16	1.000	1-7/16-12	1-7/16-12	1-7/16-12	1.67	2.80	4.47	.81
FS-1020-20-20-20	1.250	1-11/16-12	1-11/16-12	1-11/16-12	1.79	2.97	4.76	1.02
FS-1020-24-24-24	1.500	2-12	2-12	2-12	1.95	3.13	5.08	1.26

BULKHEAD BRANCH TEE

(520959)

FS-1030

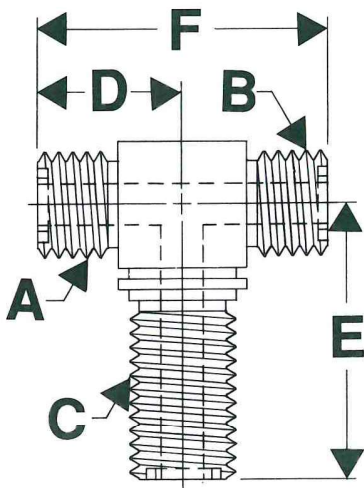

PART NO.	TUBE O.D.	THREAD A	THREAD B	THREAD C	DIM. D	DIM. E	DIM. F	HOLE SIZE
FS-1030-04-04-04	.250	9/16-18	9/16-18	9/16-18	.89	1.85	1.78	.17
FS-1030-06-06-06	.375	11/16-16	11/16-16	11/16-16	1.02	2.05	2.04	.26
FS-1030-08-08-08	.500	13/16-16	13/16-16	13/16-16	1.14	2.18	2.28	.38
FS-1030-10-10-10	.625	1-14	1-14	1-14	1.36	2.48	2.72	.48
FS-1030-12-12-12	.750	1-3/16-12	1-3/16-12	1-3/16-12	1.52	2.65	3.04	.61
FS-1030-16-16-16	1.000	1-7/16-12	1-7/16-12	1-7/16-12	1.67	2.80	3.34	.81
FS-1030-20-20-20	1.250	1-11/16-12	1-11/16-12	1-11/16-12	1.79	2.97	3.58	1.02
FS-1030-24-24-24	1.500	2-12	2-12	2-12	1.95	3.13	3.90	1.26

PART NO.	TUBE O.D.	THREAD A	THREAD B	DIM. C	DIM. D	HOLE SIZE
FS-1045-04-04	.250	9/16-18	9/16-18	.63	1.73	.17
FS-1045-06-06	.375	11/16-16	11/16-16	.74	1.91	.26
FS-1045-08-08	.500	13/16-16	13/16-16	.80	2.01	.38
FS-1045-10-10	.625	1-14	1-14	.92	2.23	.48
FS-1045-12-12	.750	1-3/16-12	1-3/16-12	1.02	2.39	.61
FS-1045-16-16	1.000	1-7/16-12	1-7/16-12	1.18	2.57	.81
FS-1045-20-20	1.250	1-11/16-12	1-11/16-12	1.26	2.64	1.02
FS-1045-24-24	1.500	2-12	2-12	1.45	2.64	1.26

45° BULKHEAD UNION ELBOW (520801)

FS-1045

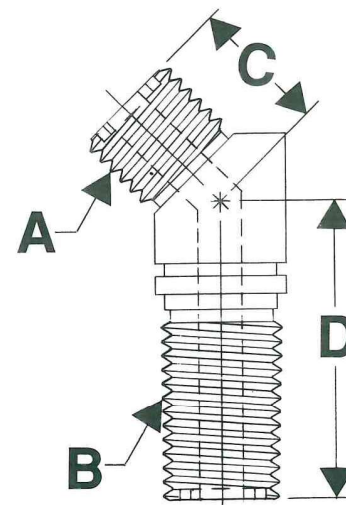

PART NO.	TUBE O.D.	THREAD A	THREAD B	DIM. C	DIM. D	HOLE SIZE
FS-1090-04-04	.250	9/16-18	9/16-18	.89	1.85	.17
FS-1090-06-06	.375	11/16-16	11/16-16	1.02	2.05	.26
FS-1090-08-08	.500	13/16-16	13/16-16	1.14	2.18	.38
FS-1090-10-10	.625	1-14	1-14	1.36	2.48	.48
FS-1090-12-12	.750	1-3/16-12	1-3/16-12	1.52	2.65	.61
FS-1090-16-16	1.000	1-7/16-12	1-7/16-12	1.67	2.80	.81
FS-1090-20-20	1.250	1-11/16-12	1-11/16-12	1.79	2.97	1.02
FS-1090-24-24	1.500	2-12	2-12	1.95	3.13	1.26

90° BULKHEAD UNION ELBOW (520701)

FS-1090

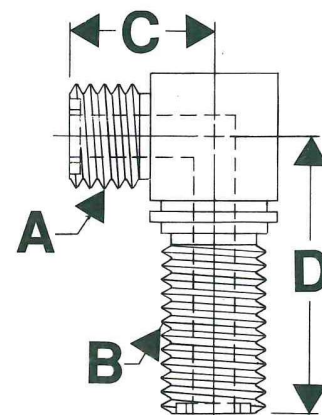

TUBE NUT

(520110)

FS-1801

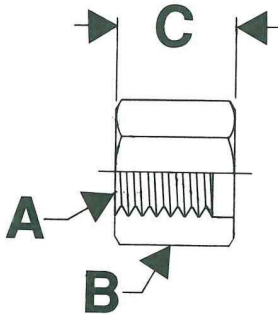

PART NO.	TUBE O.D.	THREAD A	HEX B	DIM. C
FS-1801-04	.250	9/16-18	.69	.58
FS-1801-06	.375	11/16-16	.81	.67
FS-1801-08	.500	13/16-16	.94	.83
FS-1801-10	.625	1-14	1.12	.93
FS-1801-12	.750	1-3/16-12	1.37	1.02
FS-1801-16	1.000	1-7/16-12	1.62	1.10
FS-1801-20	1.250	1-11/16-12	1.87	1.10
FS-1801-24	1.500	2-12	2.25	1.10

TUBE SLEEVE

(520115)

FS-1802

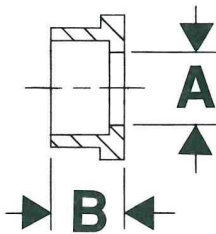

PART NO.	TUBE O.D.	DIM. A	DIM. B
FS-1802-04-04	.250	.17	.37
FS-1802-06-04	.250	.17	.41
FS-1802-06-06	.375	.27	.37
FS-1802-08-06	.375	.27	.47
FS-1802-08-08	.500	.38	.37
FS-1802-10-08	.500	.38	.53
FS-1802-10-10	.625	.48	.41
FS-1802-12-08	.500	.38	.57
FS-1802-12-10	.625	.48	.57
FS-1802-12-12	.750	.61	.55
FS-1082-16-12	.750	.61	.67
FS-1802-16-16	1.000	.81	.61
FS-1802-20-16	1.000	.81	.69
FS-1802-20-20	1.250	1.05	.61
FS-1802-24-20	1.250	1.05	.74
FS-1802-24-24	1.500	1.31	.61

STRAIGHT THREAD LOCKNUT

(520117)

FS-1804

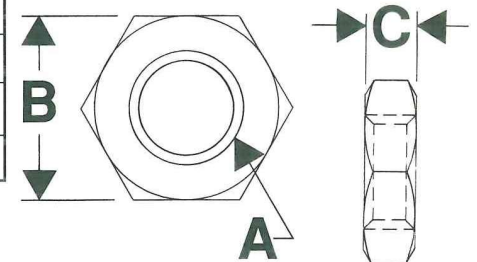

PART NO.	TUBE O.D.	THREAD A	DIM. B	DIM. C
FS-1804-04	.250	7/16-20	.625	.31
FS-1804-06	.375	9/16-18	.750	.33
FS-1804-08	.500	3/4-16	.938	.41
FS-1804-10	.625	7/8-14	1.06	.45
FS-1804-12	.750	1-1/16-12	1.37	.50
FS-1804-16	1.000	1-5/16-12	1.63	.54
FS-1804-20	1.250	1-5/8-12	1.87	.54
FS-1804-24	1.500	1-7/8-12	2.12	.54

BULKHEAD LOCKNUT

(520118)

FS-1805

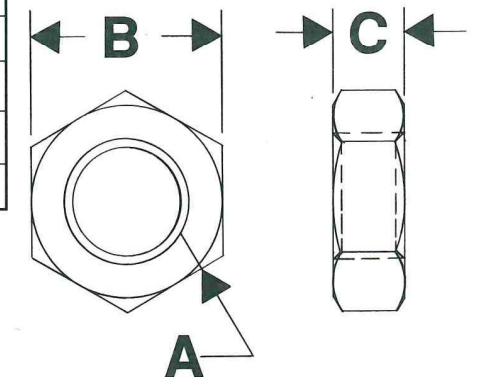

PART NO.	TUBE O.D.	THREAD A	DIM. B	DIM. C
FS-1805-04	.250	9/16-18	.81	.27
FS-1805-06	.375	11/16-16	1.00	.31
FS-1805-08	.500	13/16-16	1.12	.35
FS-1805-10	.625	1-14	1.31	.41
FS-1805-12	.750	1-3/16-12	1.50	.41
FS-1805-16	1.000	1-7/16-12	1.75	.41
FS-1805-20	1.250	1-11/16-12	2.00	.41
FS-1805-24	1.500	2-12	2.38	.41

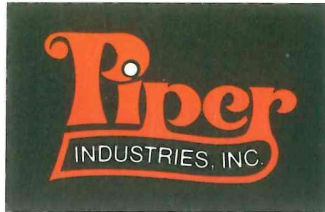

15930 Common Road • P.O. Box 41 • Roseville, MI 48066 • (313) 71

Visit us at:
www.piperindustries.com
1-800-521-1002 ** (586) 771-5100
Fax: (586) 771-9100
Email: sales@piperindustries.com

Since 1946, Piper Industries, Inc. has dedicated itself to service, quality and performance in the design and manufacturing of precision Fittings and Hydraulic Adaptors. Our standard line of Hydraulic Adaptors were designed to meet the latest SAE Standards. The SAE Part Number is shown above the Piper Part Number in the catalog.

We offer a full line of Hydraulic Adaptors from 1/8" to 2" in size. We can supply Face Seal, Specials and Manifolds that are designed to eliminate potential leaks by eliminating unnecessary joints.

Our factory is located in Roseville, Michigan in the suburbs of Detroit. We can assist you with technical help from the factory or from our experienced network of Regional Representatives in your local area.

All sizes are indicated in graduations of sixteenths of an inch according to the outside diameter of the tubing with which it will be mated. For example: 1/2 inch O.D. Tube is equal to 8/16 of an inch or a -8 size. Both Male and Female Pipe Threads are also indicated by sixteenths. For example: 1/2 NPTF is equal to 8/16 NPTF or a -8 size. When ordering Fittings, first use the series number, followed by Size A then Size B, etc. For example: FS-0790-08-08.

The following chart was designed to assist in the ordering of a standard adaptor with an additional fitting incorporated for your need. The chart below will provide you with the necessary information.

- | | |
|----------------------------|--------------------------------------|
| 1. FP -Female Pipe | 4. MF -37 deg J.I.C. Flare |
| 2. MP -Male Pipe | 5. MFS -Male Face Seal |
| 3. FOB -Female O'Ring Boss | 6. DBL-THD - Adj. Double Thread Port |

Example

